

CONSTRUCTION PLANS
FOR
JESSICA CLINTON PARK

LYING IN A PORTION OF TRACT R, PORT ST. LUCIE
SECTION 39, PLAT BOOK 15, PAGES 30, 30A-30N

CITY OF PORT SAINT LUCIE
SAINT LUCIE COUNTY, FLORIDA

CONTACTS

CIVIL ENGINEER
BOWMAN CONSULTING GROUP
301 SE OCEAN DRIVE, SUITE 301
STUART, FL 34994
PHONE: 772-283-1413

SURVEYOR
BOWMAN CONSULTING GROUP
301 SE OCEAN DRIVE, SUITE 301
STUART, FL 34994
PHONE: 772-283-1413

GENERAL NOTES

1. THE CONTRACTOR SHALL HAVE ONE SIGNED COPY OF THE APPROVED PLANS AND THE APPROPRIATE STANDARDS AND SPECIFICATIONS ALONG WITH A COPY OF ANY PERMITS AND AGREEMENTS NEEDED FOR THE JOB ON-SITE AT ALL TIMES.
2. THE CONTRACTOR SHALL MEET OR EXCEED ALL SITE WORK SPECIFICATIONS AND APPLICABLE STATE AND FEDERAL REGULATIONS FOR ALL MATERIALS AND CONSTRUCTION.
3. THE CONTRACTOR SHALL BE RESPONSIBLE FOR ALL ASPECTS OF SAFETY DURING CONSTRUCTION.
4. THE CONTRACTOR SHALL NOTIFY THE ENGINEER IF ANY SITUATION THAT IS NOT IDENTIFIED IN THE PLANS OR SPECIFICATIONS IS ENCOUNTERED.
5. NO REVISION SHALL BE MADE TO THESE PLANS WITHOUT THE APPROVAL OF THE ENGINEER OF RECORD.
6. THE CONTRACTOR SHALL BE RESPONSIBLE FOR KEEPING ROADWAYS FREE AND CLEAR OF ALL CONSTRUCTION DEBRIS AND DIRT TRACKED FROM THE SITE.
7. ANY REFERENCE TO PUBLISHED STANDARDS SHALL REFER TO THE LATEST REVISION OF SAID STANDARD, UNLESS SPECIFICALLY STATED OTHERWISE.
8. ALL NECESSARY INSPECTIONS AND/OR CERTIFICATIONS REQUIRED BY CODES AND/OR UTILITY SERVICE COMPANIES SHALL BE PERFORMED PRIOR TO ANNOUNCED BUILDING POSSESSION AND THE FINAL CONNECTION OF SERVICES.

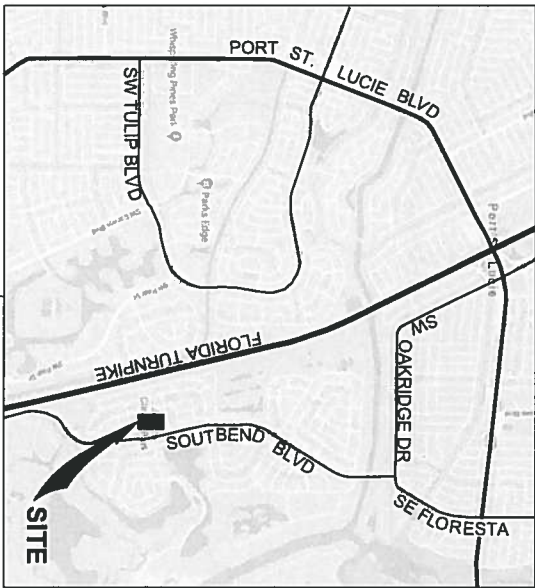

LOCATION MAP
N.T.S.

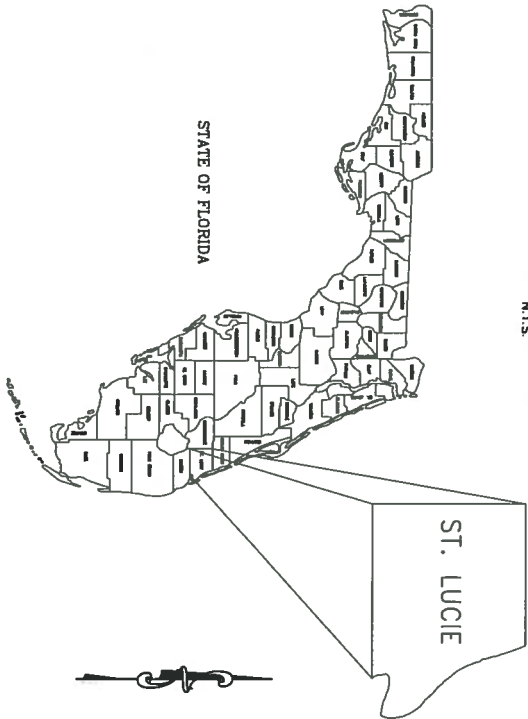

VICINITY MAP
N.T.S.

FINAL DESIGN

DRAWING INDEX

- | | |
|---------|-----------------------------------|
| SHEET 1 | COVER SHEET |
| SHEET 2 | OVERALL SITE PLAN |
| SHEET 3 | SITE PLAN |
| SHEET 4 | DEMOLITION & EROSION CONTROL PLAN |
| SHEET 5 | PAVING, GRADING & DRAINAGE PLAN |
| SHEET 6 | SITE DETAILS |
| SHEET 7 | NOTES |
| SHEET 8 | LANDSCAPE PLAN |
| SHEET 9 | SITE LIGHTING PLAN |

Bowman Consulting Group, Ltd., Inc.
301 SE Ocean Blvd, Suite 301
Stuart, Florida 34994
Phone: (772) 283-1413
Fax: (772) 220-7861
www.bowmanconsulting.com
© Bowman Consulting Group, Ltd.

Bowman
CONSULTING
PROFESSIONAL SURVEYORS AND MAPPERS, CERTIFICATE NO. LB. 8830
BOARD OF PROFESSIONAL ENGINEERS, CERTIFICATE OF AUTHORIZATION NO. 38462

JESSICA CLINTON PARK
PARKING AREA EXPANSION
COVER SHEET

FLORIDA

ST. LUCIE

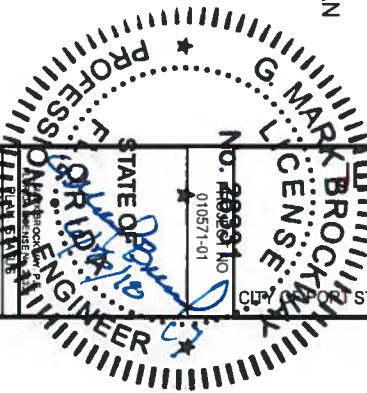

THE ELEVATIONS SHOWN ARE REFERENCED TO THE
NORTH AMERICAN VERTICAL DATUM OF 1988 (NAVD88)

DATE	06/18/2016
FILE No.	010571-01
SHEET	1 of 9

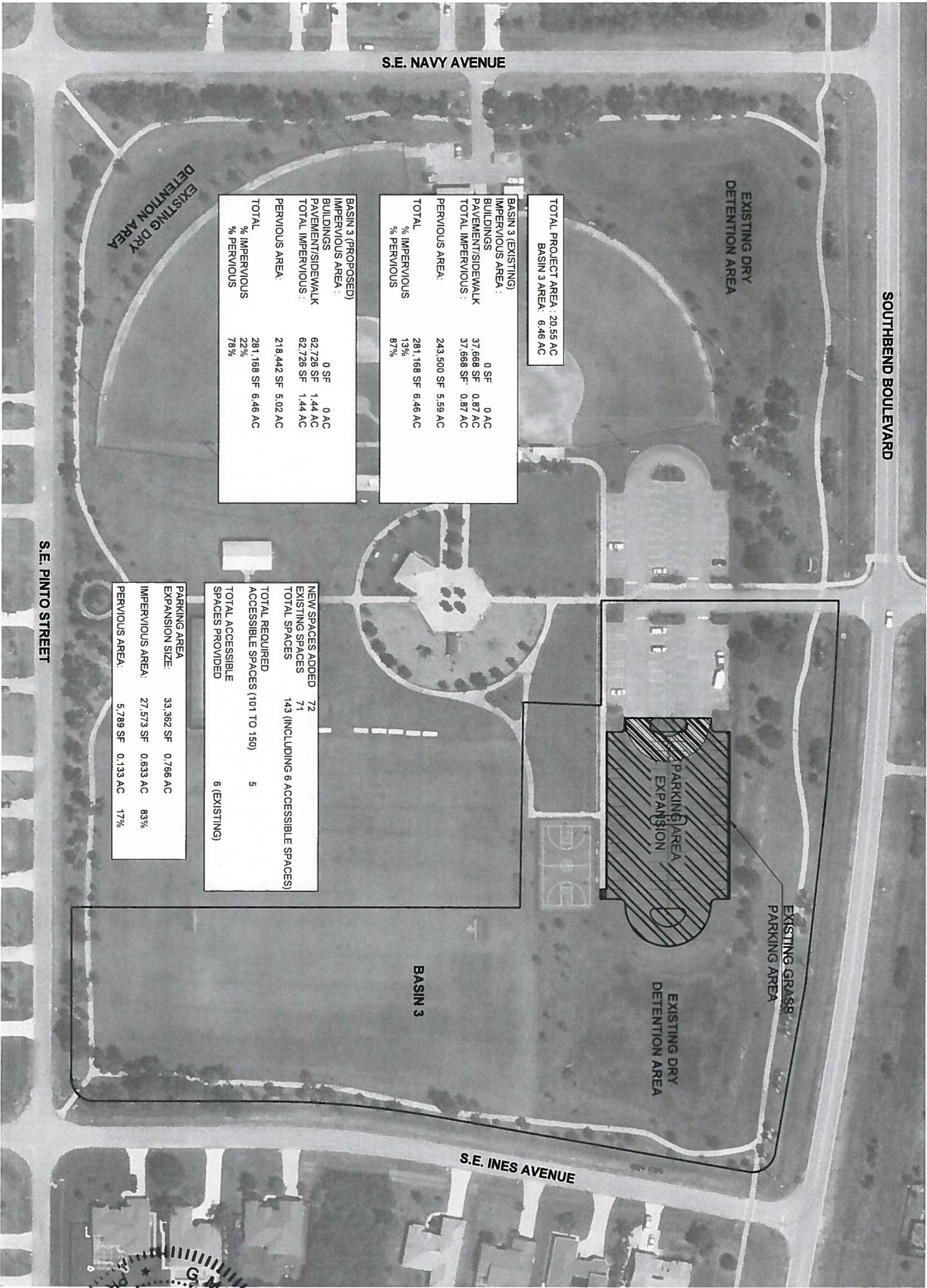
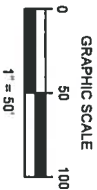

TOTAL PROJECT AREA : 20.55 AC
BASIN 3 AREA : 6.46 AC

BASIN 3 (EXISTING)
IMPERVIOUS AREA :
BUILDINGS 0 SF 0 AC
PAVEMENT/SIDEWALK 37,668 SF 0.87 AC
TOTAL IMPERVIOUS : 37,668 SF 0.87 AC
PERVIOUS AREA: 243,500 SF 5.59 AC
TOTAL 281,168 SF 6.46 AC
% IMPERVIOUS 13%
% PERVIOUS 87%

BASIN 3 (PROPOSED)
IMPERVIOUS AREA :
BUILDINGS 0 SF 0 AC
PAVEMENT/SIDEWALK 62,726 SF 1.44 AC
TOTAL IMPERVIOUS : 62,726 SF 1.44 AC
PERVIOUS AREA: 218,442 SF 5.02 AC
TOTAL 281,168 SF 6.46 AC
% IMPERVIOUS 22%
% PERVIOUS 78%

NEW SPACES ADDED 72
EXISTING SPACES 71
TOTAL SPACES 143 (INCLUDING 6 ACCESSIBLE SPACES)
TOTAL REQUIRED ACCESSIBLE SPACES (101 TO 150) 5
TOTAL ACCESSIBLE SPACES PROVIDED 6 (EXISTING)

PARKING AREA EXPANSION SIZE: 33,362 SF 0.766 AC
IMPERVIOUS AREA: 27,573 SF 0.633 AC 83%
PERVIOUS AREA: 5,789 SF 0.133 AC 17%

FINAL DESIGN

JESSICA CLINTON PARK
PARKING AREA EXPANSION
OVERALL SITE PLAN

Bowman Consulting Group, Ltd., Inc.
301 SE Ocean Blvd, Suite 301
Stuart, Florida 34994
Phone: (772) 283-1413
Fax: (772) 220-7881
www.bowmanconsulting.com
© Bowman Consulting Group, Ltd.

Bowman
CONSULTING
PROFESSIONAL SURVEYORS AND MAPPERS, CERTIFICATE NO. LB. 6030
BOARD OF PROFESSIONAL ENGINEERS, CERTIFICATE OF AUTHORIZATION NO. 35462

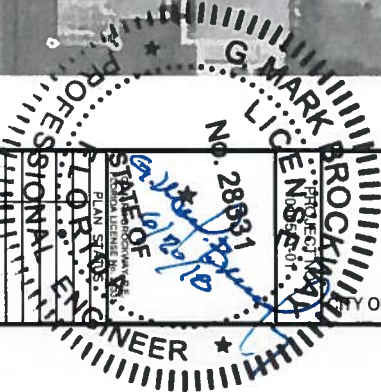

LEGEND

EXISTING TREE (TO REMAIN)

EXISTING LIGHT POLE

EXISTING ELECTRICAL PULL BOX

TREE TO BE REMOVED

PROPOSED LIGHT POLE & FIXTURE

0

20

40

GRAPHIC SCALE

1" = 20'

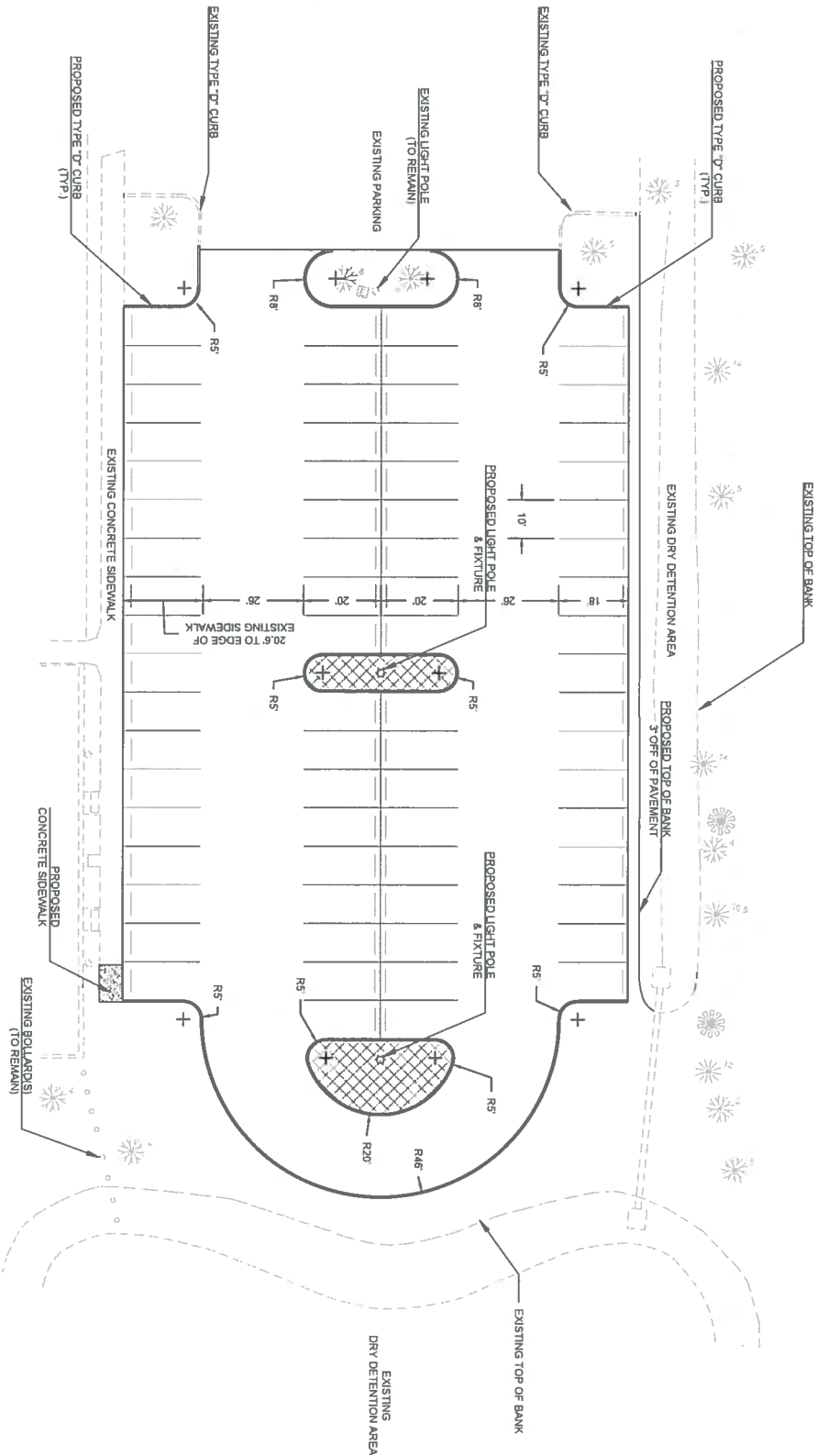

FINAL DESIGN

DATE

DESCRIPTION

JAC

DGP

GMB

DESIGN

DRAWN

CHKD

SCALE:

AS SHOWN

JOB No. 010571

DATE 06/18/2018

FILE No. 010571-01

SHEET 3 of 9

JESSICA CLINTON PARK
PARKING AREA EXPANSION
SITE PLAN

FLORIDA

G. MARK BROCKWALD
No. 28331
Professional Engineer
010571-01

STATE OF FLORIDA
ENGINEER

FLORIDA
010571-01

Bowman Consulting Group, Ltd., Inc.
301 SE Ocean Blvd, Suite 301
Stuart, Florida 34994
Phone: (772) 283-1413
Fax: (772) 220-7881
www.bowmanconsulting.com
© Bowman Consulting Group, Ltd.

Bowman
CONSULTING

PROFESSIONAL SURVEYORS AND MAPPERS, CERTIFICATE NO. LB. 8830
BOARD OF PROFESSIONAL ENGINEERS, CERTIFICATE OF AUTHORIZATION NO. 38482

Cad file name: P:\010571 - Port St Lucie\010571-01-001 (DWG) - Jessica Clinton Park\Engineering\Planning\010571-0-02-ST.dwg 06/18/18



GRAPHIC SCALE



1" = 20'

NAVD88

LEGEND

- REMOVE EXISTING ASPHALT
- SILT FENCE
- LIMIT OF DISTURBANCE
- EXISTING SPOT ELEVATION
- EXISTING TREE (TO REMAIN)
- EXISTING LIGHT POLE
- EXISTING ELECTRICAL PULL BOX
- TREE TO BE REMOVED
- PROPOSED LIGHT POLE & FIXTURE

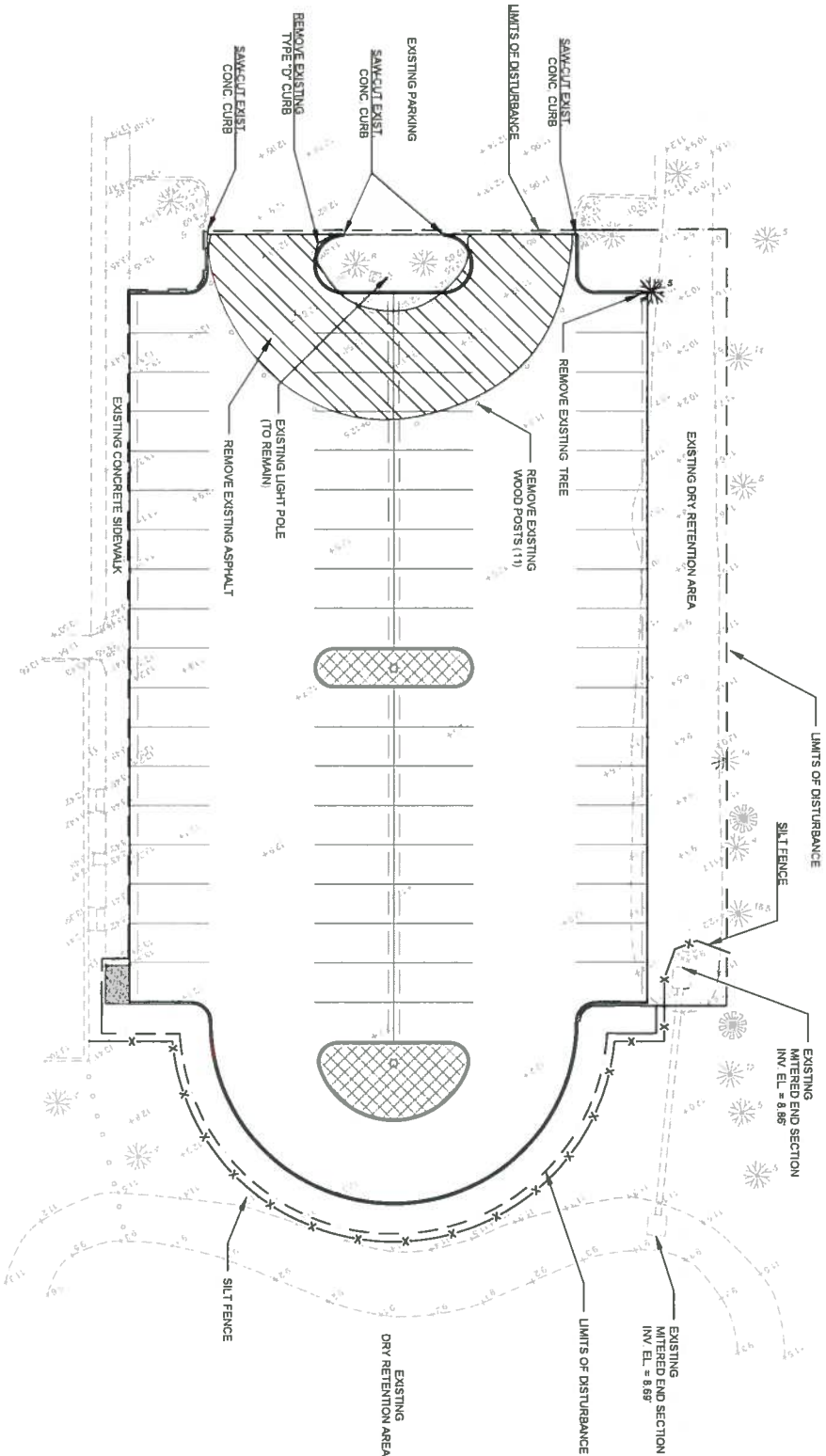

FINAL DESIGN

Cell file name: P:\010571 - Port St. Lucie\010571-01-001 (DWG) - Jessica Clinton Park\Engineering\Engineering Plans\010571-01-001-Site.dwg 06/19/18

JESSICA CLINTON PARK
PARKING AREA EXPANSION
DEMOLITION & EROSION CONTROL PLAN

CITY OF PORT ST. LUCIE

FLORIDA

Bowman Consulting Group, Ltd., Inc.
301 SE Ocean Blvd, Suite 301
Stuart, Florida 34994
Phone: (772) 283-1413
Fax: (772) 220-7861
www.bowmanconsulting.com
© Bowman Consulting Group, Ltd.

Bowman
CONSULTING

PROFESSIONAL SURVEYORS AND MAPPERS, CERTIFICATE NO. LB. 0030
BOARD OF PROFESSIONAL ENGINEERS, CERTIFICATE OF AUTHORIZATION NO. 38462

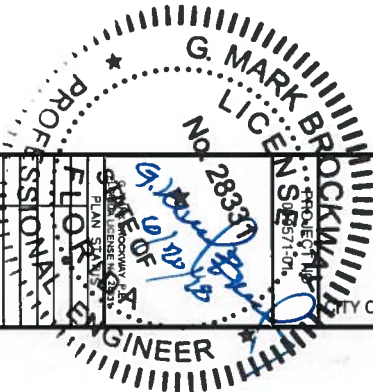

DATE	DESCRIPTION
JAC	DGP
DESIGN	DRAWN
SCALE:	AS SHOWN
JOB No.	010571
DATE	06/19/2018
FILE No.	010571-01

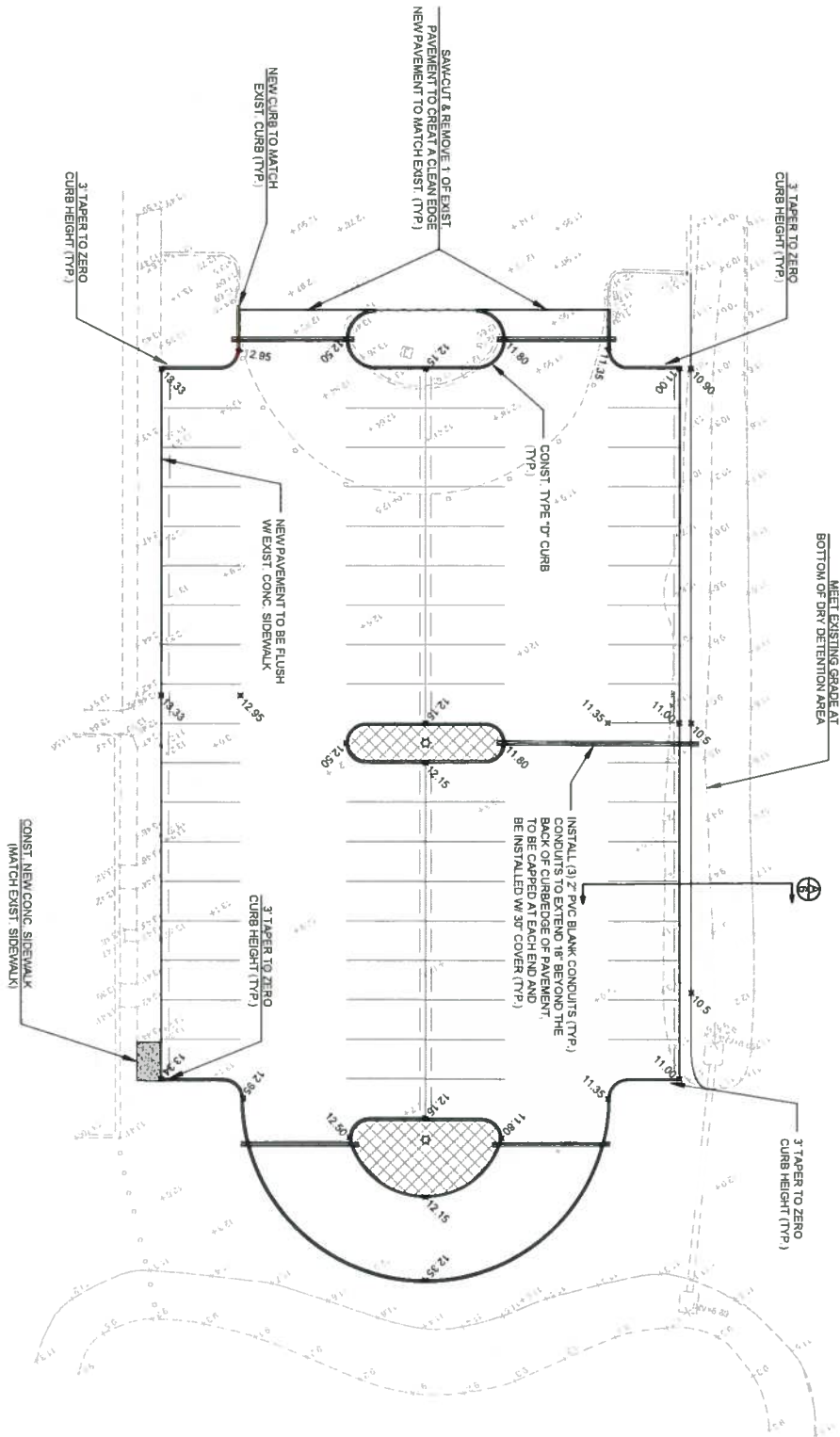

LEGEND

- EXISTING SPOT ELEVATION
 - PROPOSED ELEVATION
 - PROPOSED CONCRETE SIDEWALK
- NOTE: SOD ALL DISTURBED AREAS

FINAL DESIGN

Cad file name: P:\010571 - Port St Lucie\010571-01-001 (DWG) - Jessica Clinton Park\Engineering\Grading Plans\010571-0-02-SIT.dwg 06/19/18

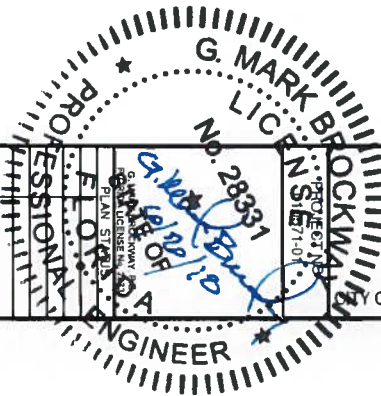

JESSICA CLINTON PARK
PARKING AREA EXPANSION
PAVING, GRADING & DRAINAGE PLAN

CITY OF PORT ST. LUCIE

FLORIDA

Bowman Consulting Group, Ltd., Inc.
301 SE Ocean Blvd, Suite 301
Stuart, Florida 34994
Phone: (772) 283-1413
Fax: (772) 220-7881
www.bowmanconsulting.com
© Bowman Consulting Group, Ltd.

Bowman
CONSULTING

PROFESSIONAL SURVEYORS AND MAPPERS, CERTIFICATE NO. LB. 0030
BOARD OF PROFESSIONAL ENGINEERS, CERTIFICATE OF AUTHORIZATION NO. 38462

DATE	DESCRIPTION
JAC	DGP
DESIGN	DRAWN
SCALE:	AS SHOWN
JOB No. 010571	
DATE 06/19/2018	
FILE No. 010571-01	
SHEET	5 of 9

